



Smart & Simpool

LIFEBUOY®

Make Your Pool Safer

# BCONE® SOLO

## Installation & Operation Guide

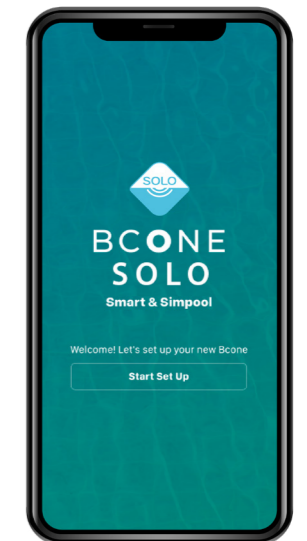
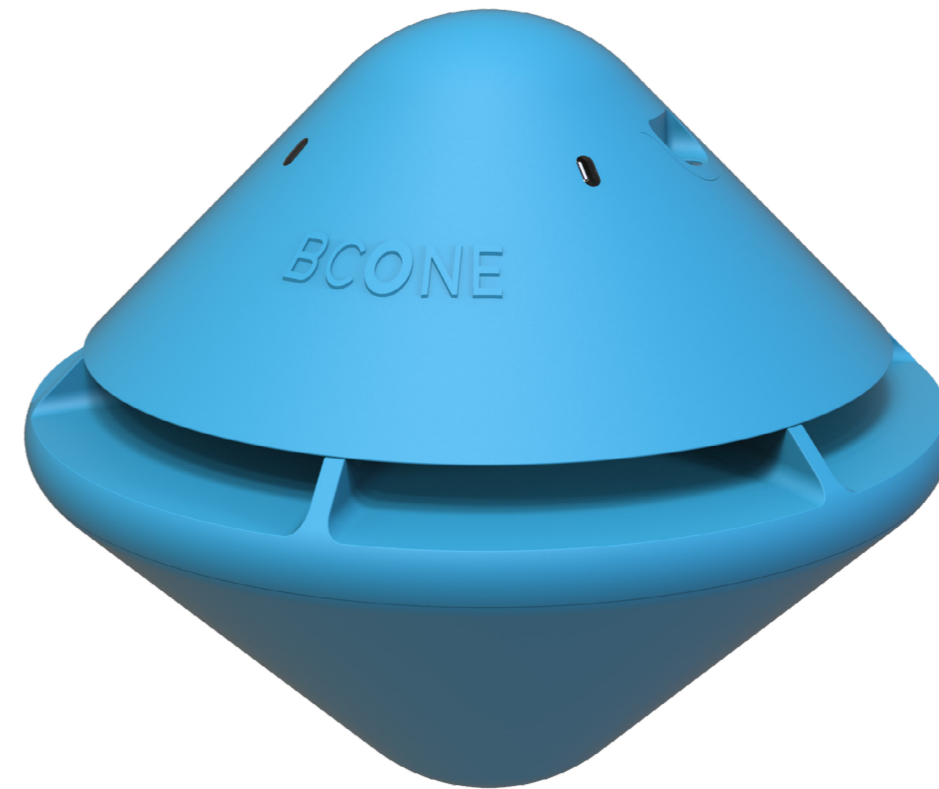

85 dB alarm at 10 feet

## HOME

### – **SAFETY**

General Safety Instructions

Alkaline Batteries Safety Guidelines

### – **INTRODUCTION**

Overview

Pool Unit

### – **GETTING STARTED**

Opening the Box

Recommendations for Pool Unit  
Installation

Multiple BCone® Solo Installation  
Recommendations

Setting Up the Pool Unit

Starting BCone® Solo

### – **OPERATION**

Operation Modes

On Mode

Off Mode

Swim Mode

Adjusting Sensitivity

Turning Alarm Off

### – **SERVICE**

Troubleshooting

Replacing Pool Unit Batteries

Shut Down and Storage

Technical Specifications

Contact Information

# SAFETY

## GENERAL SAFETY INSTRUCTIONS

- Read this guide fully prior to use.
- BCone® Solo is exclusively a safety device and is not a lifesaving product.
- **Under no circumstances should you relate to this product as a substitute for other means of safety, such as a lifeguard, parental supervision, fences, gates and so on.**
- This device may contain small parts that may be a choking hazard to children under 3 years. Keep small parts away from children.
- This device is not a toy, do not allow children to operate or play with it because children could hurt themselves or others or damage the device.
- Without detracting from the aforementioned, your attention is drawn to the fact that the product may not sound a warning in cases of gradual entry into the pool.
- Ensure that the system covers the entire area of the pool and if necessary, adjust the sensitivity of the system.
- Do not leave objects in the pool when the system is activated.
- Opening the BCone® Solo unit for service or maintenance must be done by qualified service personnel only, with the exception of opening the Pool Unit battery compartment to replace the batteries (see [Replacing Pool Unit Batteries](#)).
- Used electrical and electronic products should not be mixed with general household waste.

## ALKALINE BATTERIES SAFETY GUIDELINES

The Pool Unit contains two Alkaline batteries. The following list describes the safety guidelines for maintaining and disposing of the batteries:

- Mind the polarity of the batteries when placing them in the battery compartment.
- Do not charge batteries. Charging may result in electrolyte leakage and/or damage.
- When replacing batteries, replace all of them at the same time with new batteries of the same type.
- Exhausted batteries should be immediately removed from the equipment and disposed of.
- Do not heat batteries.
- Do not dispose of batteries in fire.
- Keep batteries out of the reach of children. Do not allow children to replace batteries without adult supervision.
- **Battery Disposal** – do not throw batteries in the trash. Discard batteries at an appropriate recycling location. Batteries shall be disposed of in accordance with local regulations.

# COMPLIANCE INFORMATION

## EUROPEAN COMMUNITY

This equipment complies with:

- IP68 Waterproof
- Electromagnetic Compatibility (EMC) Directive, 2014/30/EU
- Radio Equipment Directive (RED), 2014/53/EU
- WEEE Directive 2002/96/EC
- Restriction of Hazardous Substances Directive (RoHS) 2011/65/EU
- Lead-Free Compliance
- Reach and Directive 2011/65/EU (RoHS)

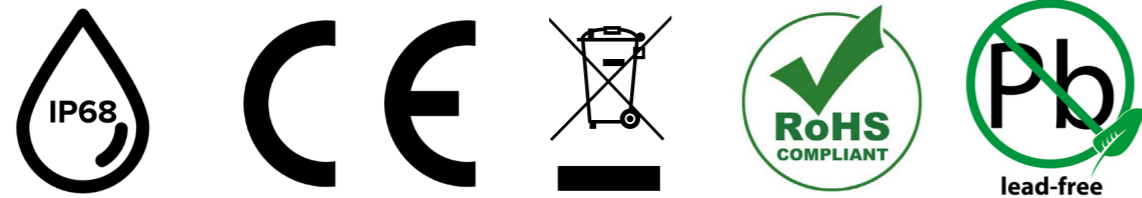

## ELECTROMAGNETIC COMPATIBILITY

GENERAL INFORMATION	TECHNOLOGY	MODULATION	FREQUENCY OPERATION	BANDWIDTH
<b>Product Name:</b> BCone® Pool Unit <b>Model:</b> LBPABCPU01 <b>FCC ID:</b> 2AOXNBCPU1	Proprietary RF 433.27 MHz	2GFSK	433.2 MHz - 433.3 MHz	100 KHz
	BLE 2.4 GHz	GFSK	2402.00 MHz - 2480.00 MHz	78000 KHz

## ICASA - SOUTH AFRICA



BCone® Pool Unit: TA-2021/2948 Approved.

**Complies with US California Proposition 65.**

**Important: This device is not intended to replace any other safety consideration, such as adult supervision, lifeguards, fences, gates, pool covers, locks, and so forth. Some devices may not detect gradual entry.**

## FCC (FEDERAL COMMUNICATIONS COMMISSION) - THE UNITED STATES OF AMERICA

BCone® Pool Unit Model: **LBPABCPU01**

BCone® Pool Unit FCCID: **2AOXNBCPU1**

This device complies with part 15 of the FCC Rules. Operation is subject to the following two conditions:

- (1) This device may not cause harmful interference, and
- (2) This device must accept any interference received, including interference that may cause undesired operation.

**Note:** This equipment has been tested and found to comply with the limits for a Class B digital device, pursuant to Part 15 of the FCC Rules. These limits are designed to provide reasonable protection against harmful interference in a residential installation. This equipment generates, uses and can radiate radio frequency energy and, if not installed and used in accordance with the instructions, may cause harmful interference to radio communications. However, there is no guarantee that interference will not occur in a particular installation. If this equipment does cause harmful interference to radio or television reception, which can be determined by turning the equipment off and on, the user is encouraged to try to correct the interference by one or more of the following measures:

- Reorient or relocate the receiving antenna.
- Increase the separation between the equipment and receiver.
- Connect the equipment into an outlet on a circuit different from that to which the receiver is connected.
- Consult the dealer or an experienced radio/TV technician for help.

**Important:** Changes or modifications to this equipment not expressly approved by the party responsible for compliance (Lifebuoy® Ltd.) could void the user's authority to operate the equipment.

**Warning:** To comply with FCC RF Exposure compliance requirements, the device (**Pool Unit**) should be located at a distance of at least 5 cm from all persons during normal operation. These specifications are due to the typical device usage and the internal construction of the antenna with plastic enclosure providing these distances. The antennas used for this product must not be co-located or operated in conjunction with any other antenna or transmitter.

## IC CANADA ID:

BCone® Pool Unit IC: **27681-BCPU1**

This Class B digital apparatus complies with Canadian ICES-003.

Cet appareil numérique de la classe B est conforme à la norme NMB-003 du Canada.

## IC STATEMENTS

This device contains licence-exempt transmitter(s)/receiver(s) that comply with Innovation, Science and Economic Development Canada's licence-exempt RSS(s). Operation is subject to the following two conditions:

- (1) This device may not cause interference.
- (2) This device must accept any interference, including interference that may cause undesired operation of the device.

L'émetteur/récepteur exempt de licence contenu dans le présent appareil est conforme aux CNR d'Innovation, Sciences et Développement économique Canada applicables aux appareils radio exempts de licence. L'exploitation est autorisée aux deux conditions suivantes :

- 1) L'appareil ne doit pas produire de brouillage;
- 2) L'appareil doit accepter tout brouillage radioélectrique subi, même si le brouillage est susceptible d'en compromettre le fonctionnement.



**NOTE:** To view the Regulatory ID for this device, on the BCone® Solo app, go to the About section, or visit [www.lifebuoyalarm.com](http://www.lifebuoyalarm.com).

## INTRODUCTION

This chapter introduces the BCone® Solo system and includes:

- **Overview**
- **Pool Unit**

## OVERVIEW

BCone® Solo system includes the following components:

**Pool Unit** – attached to the side of the pool and floats on the water. Its sounds an alarm when needed.

**Mobile Application** – BCone® Solo mobile application communicates with the Pool Unit. It provides access to the system settings and allows for remote monitoring.

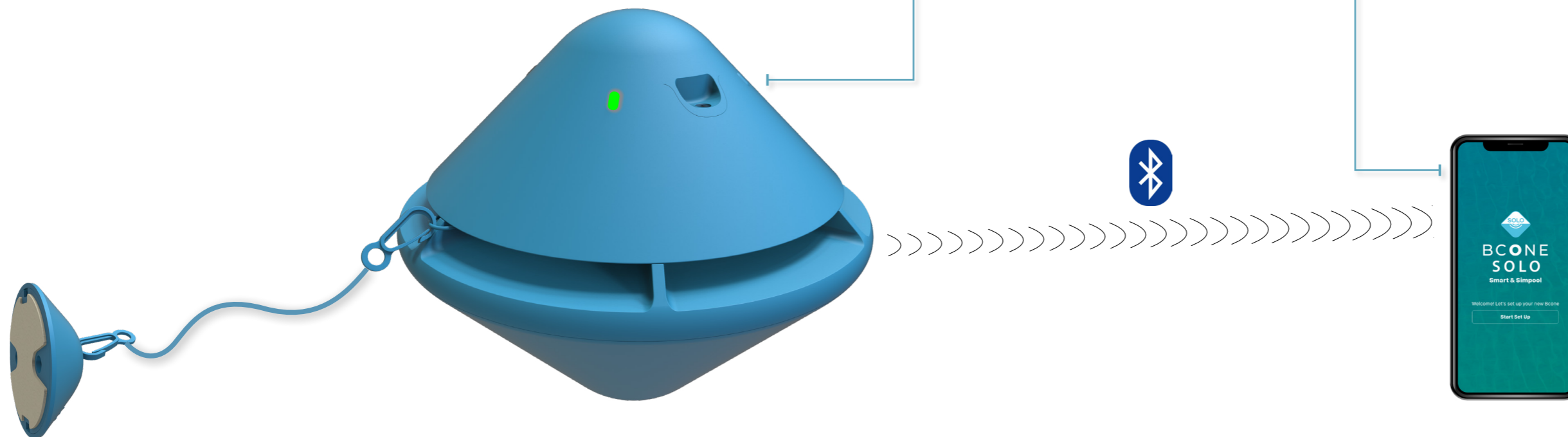

**NOTE:** Communication between the application and the Pool Unit occurs only when the unit is within Bluetooth range of the mobile device.

## POOL UNIT

The Pool Unit includes the following components:

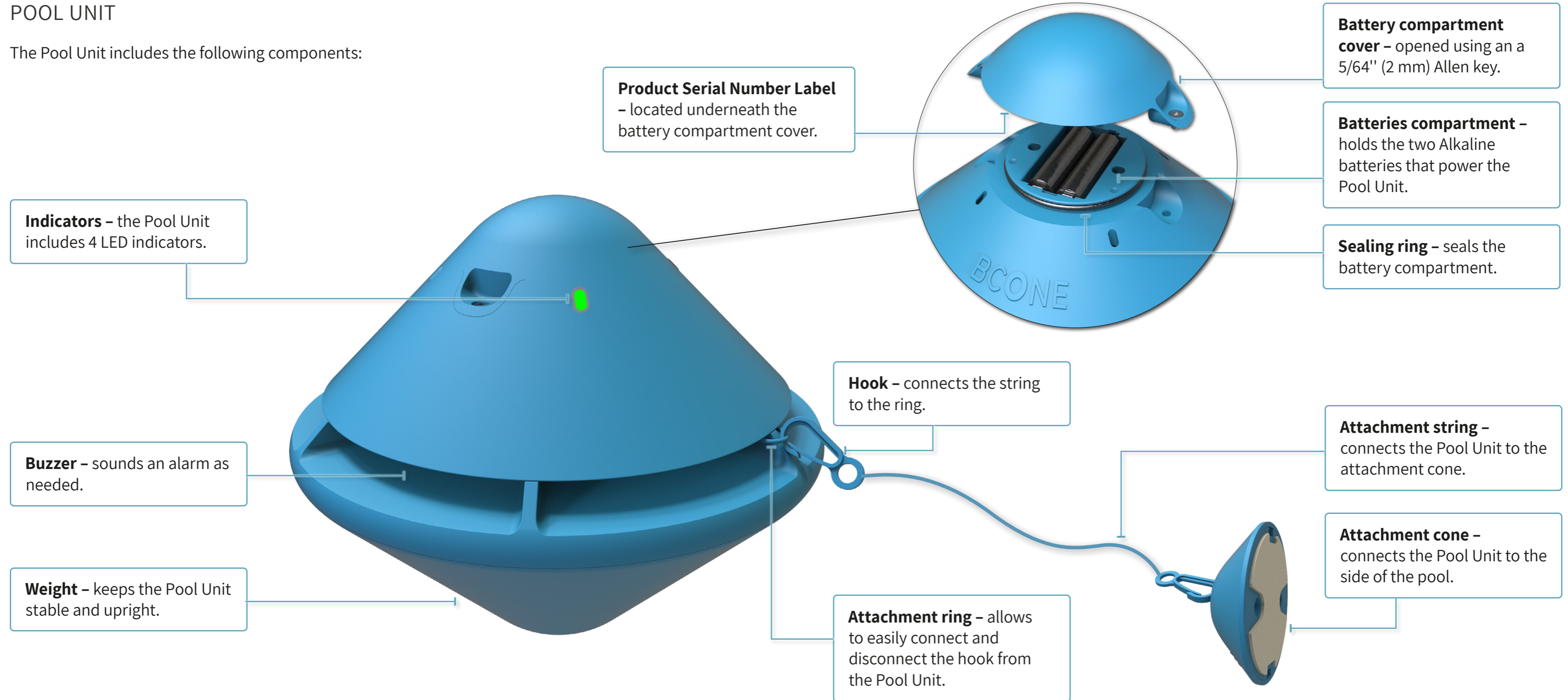





## GETTING STARTED

This chapter reviews the BCone® Solo first time use and includes:

- **Opening the Box**
- **Recommendations for Pool Unit Installation**
- **Multiple BCone® Solo Installation Recommendations**
- **Setting Up the Pool Unit**
- **Starting BCone® Solo**

## OPENING THE BOX

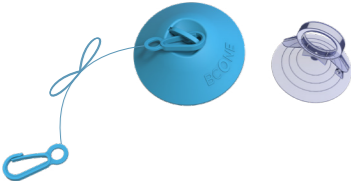
The BCone® Solo Pool Alarm System package contains the following:

	ITEM	QTY	COMMENTS
	Pool Unit	1	Includes 2 AA batteries.
	Attachment Kit	1	<b>The attachment kit includes:</b> 1 attachment cone 1 suction cup 1 attachment string 2 hooks
	Quick Start Guide	1	Guide is in four languages: - English - Spanish - French - German

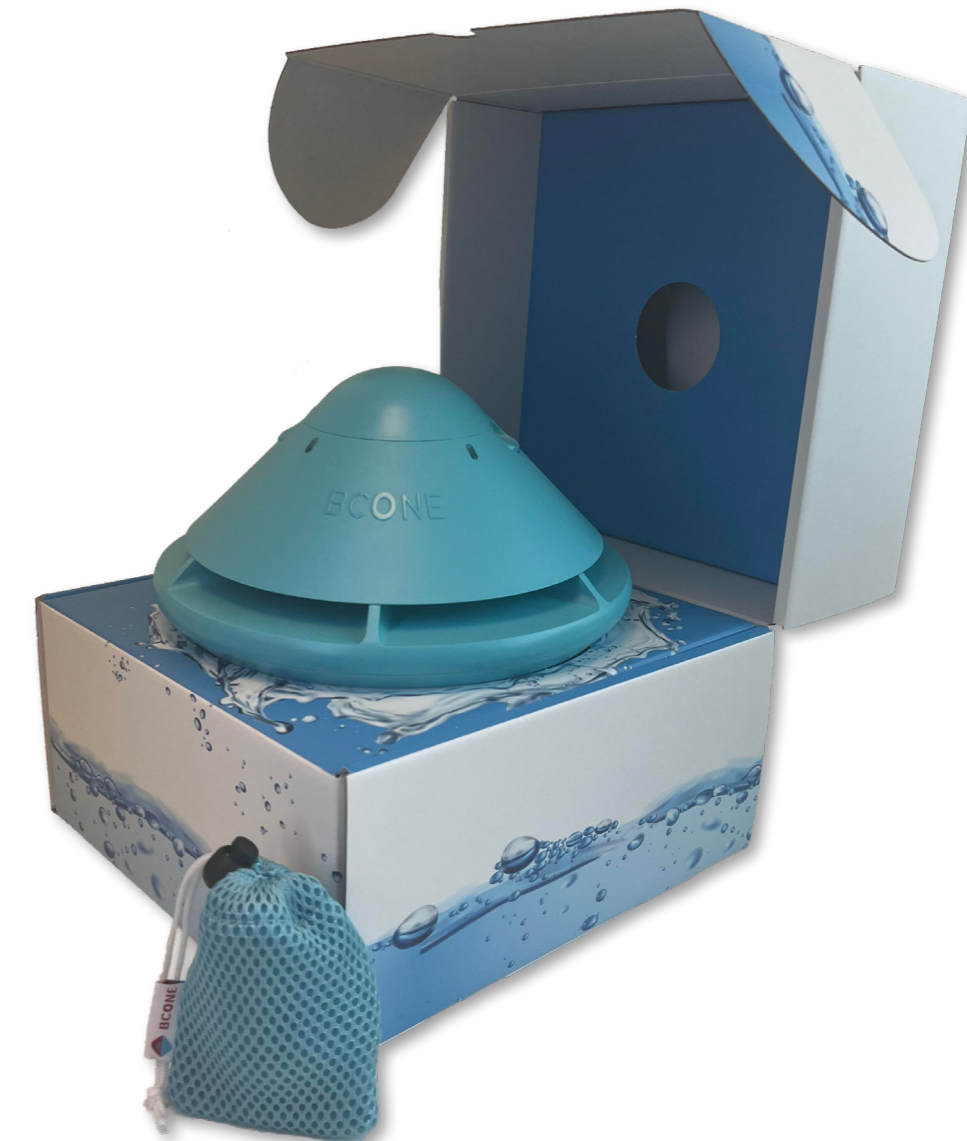

**NOTE:** The box is made from durable cardboard and has been specially designed to protect the contents. If the box arrived open or damaged or if a part is missing, please contact our customer service:

**Email** – [support@lifebuoyalarm.com](mailto:support@lifebuoyalarm.com)

**Phone** – 1-800-720-7160 (toll free in US & Canada only)

## RECOMMENDATIONS FOR POOL UNIT INSTALLATION

Consider the following guidelines before installing the Pool Unit:

- A single Pool Unit can cover pool area of 20' x 40'.
- Place the Pool Unit away from any obstruction in the pool, such as a pool drain or any other pool element.
- Use the provided attachment kit to anchor the Pool Unit.
- Place the Pool Unit so that it is in line of sight with the wall on which the Home Unit is installed.
- Depending on the pool shape, place the Pool Unit according to the drawing.

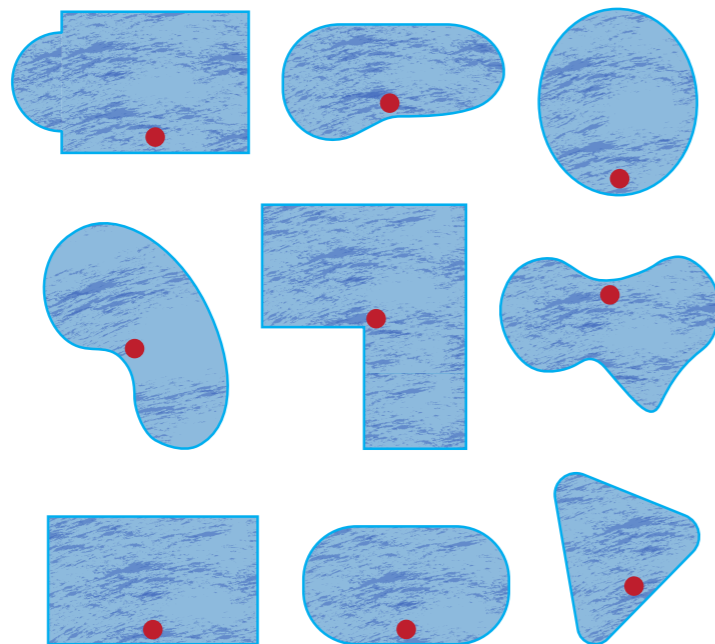

## MULTIPLE BCONE® SOLO INSTALLATION RECOMMENDATIONS

The BCone® Solo application allows pairing multiple Pool Units. Two or more Pool Units can be installed in one pool, or several units can be installed in several pools.

When placing two Pool Units in one pool, place them according to one of the drawings below (depending on the pool shape).

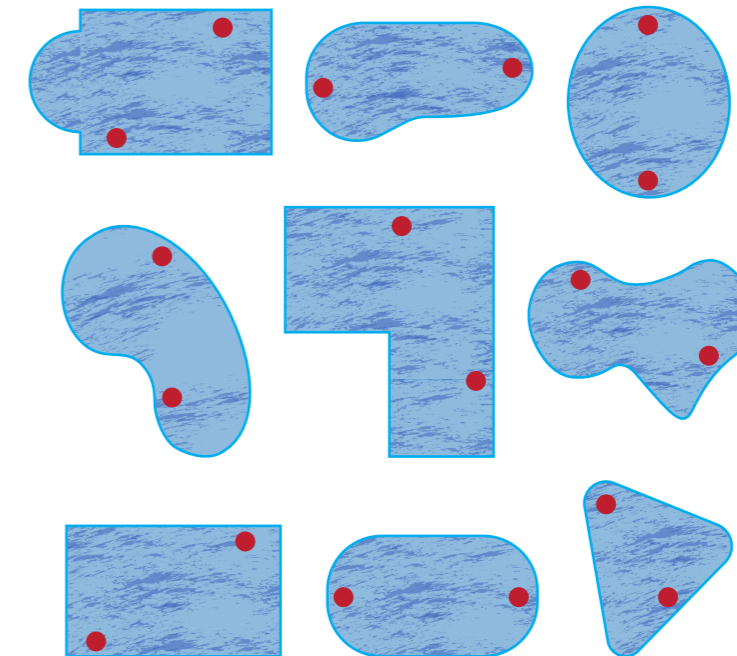

## SETTING UP THE POOL UNIT

Perform the following steps to set up the Pool Unit:

**NOTE:** Choose the Pool Unit location based on the [Recommendations for Pool Unit Installation](#).

**NOTE:** The Pool Unit is delivered operational and already paired with the Home Unit. There is no need to turn on the Pool Unit power.

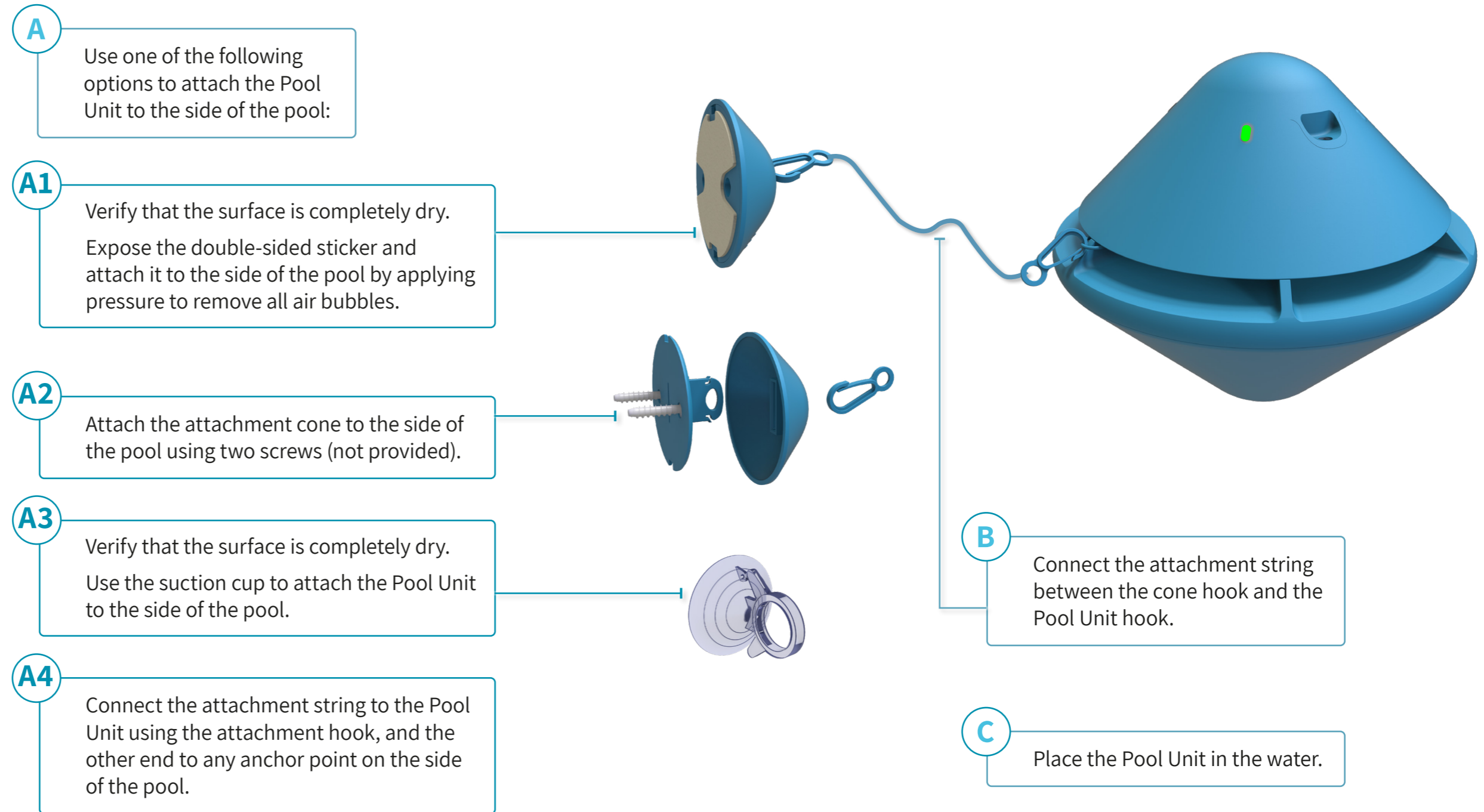

## STARTING BCONE® SOLO

### INSTALLATION USING THE APP

Once the Pool Unit is set up, perform the following steps to set up BCone® Solo using the mobile app:

**A** Download the BCone® Solo mobile application from Apple App Store



or Google Play Store



 **TIP:** Scanning the QR code using a mobile device links directly to the BCone® Solo app download page.

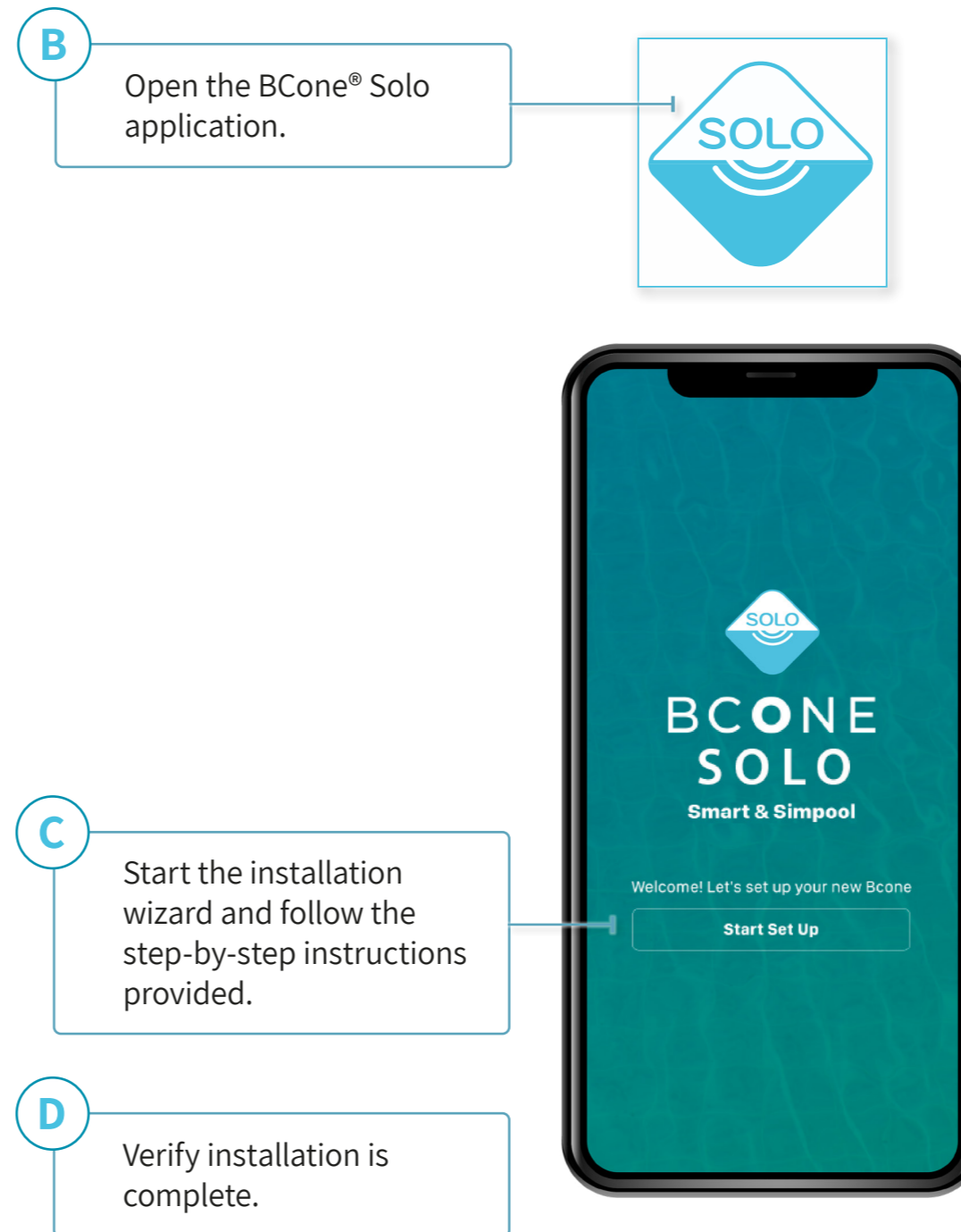

## OPERATION

This chapter reviews the BCone® Solo routine operation and includes:

- **Operation Modes**
- **On Mode**
- **Off Mode**
- **Swim Mode**
- **Adjusting Sensitivity**
- **Turning Alarm Off**

## OPERATION MODES

Select one of the following operation modes according to the current use of the pool:

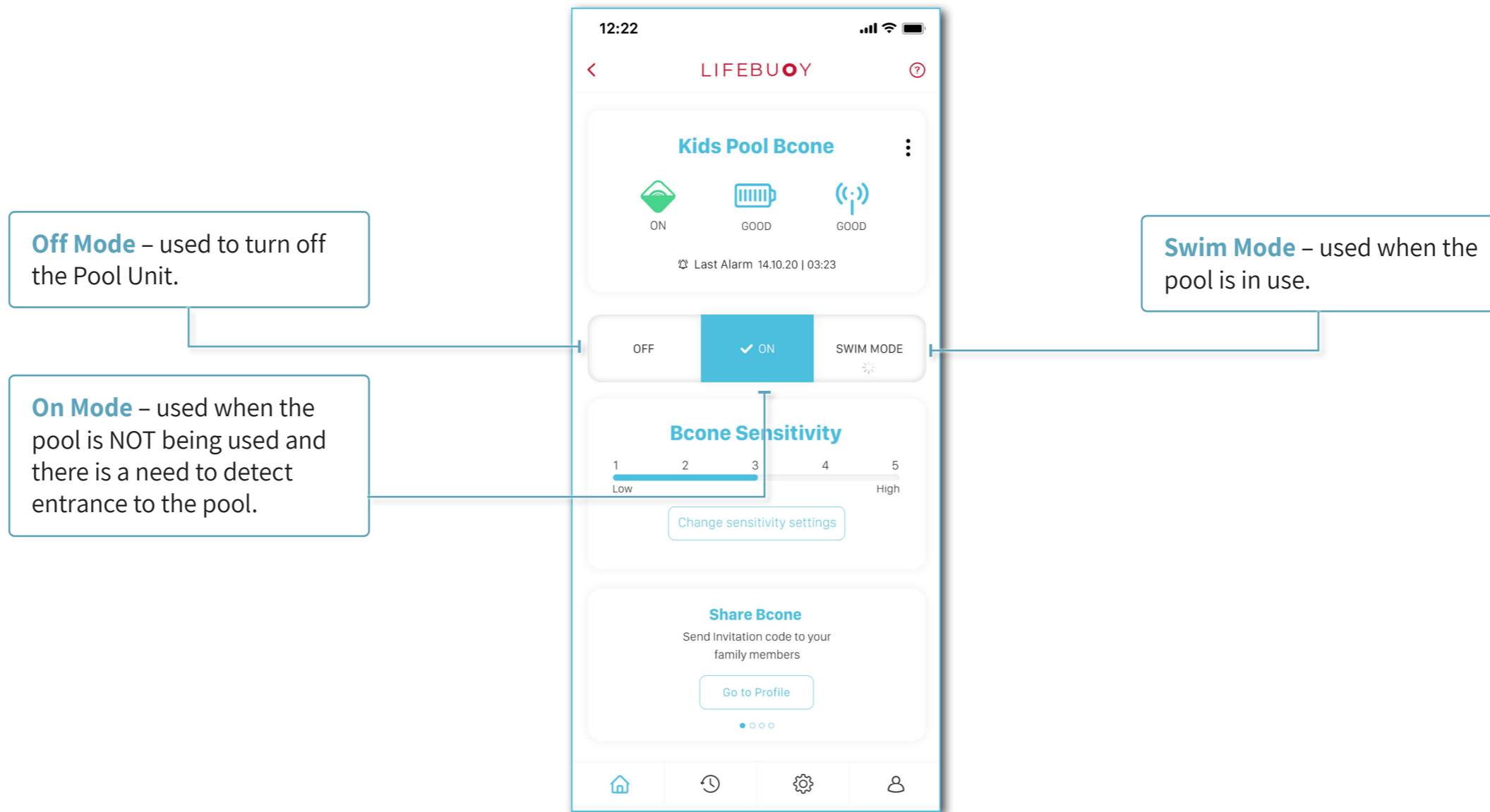

The screenshot shows the mobile app interface for 'Kids Pool Bcone'. At the top, there are three status indicators: 'ON' (green), 'GOOD' (battery), and 'GOOD' (signal). Below these is a mode selector with three options: 'OFF', 'ON' (selected with a checkmark), and 'SWIM MODE'. A 'Bcone Sensitivity' slider is set to level 3, with a 'Change sensitivity settings' button below it. At the bottom, there is a 'Share Bcone' section with a 'Go to Profile' button. Three callout boxes provide descriptions for the modes:

- Off Mode** – used to turn off the Pool Unit.
- On Mode** – used when the pool is NOT being used and there is a need to detect entrance to the pool.
- Swim Mode** – used when the pool is in use.

## ON MODE

"On" mode is used when the pool is not being used and there is a need to detect entrance to the pool. Activate On mode using the mobile application as follows:

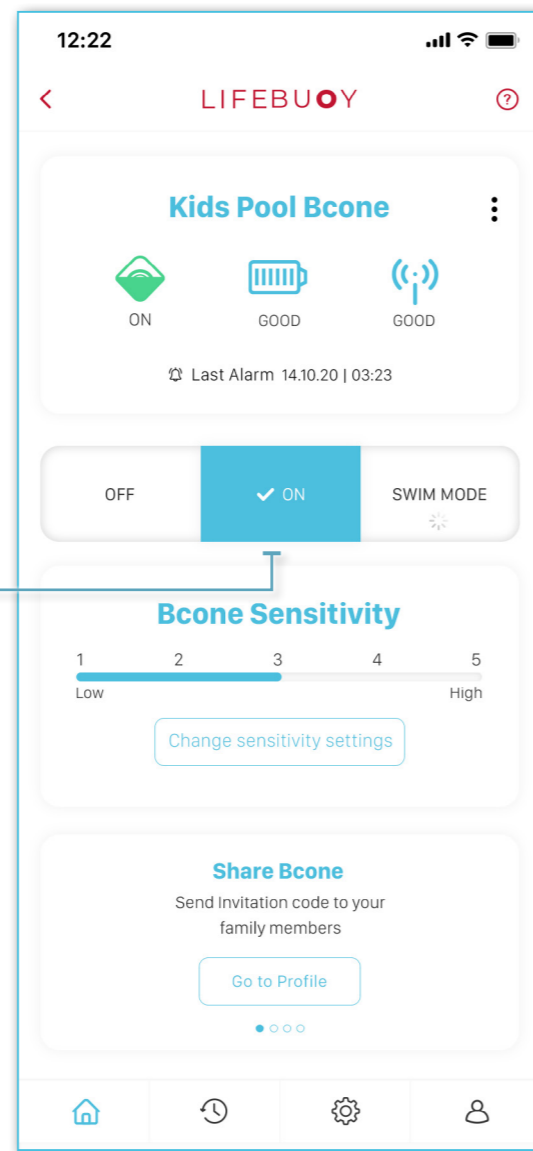

## OFF MODE

"Off" mode is used to turn off the Pool Unit. In Off mode, the system does not sound an alarm when entrance to the pool is detected.

Activate Off mode using the mobile application as follows:

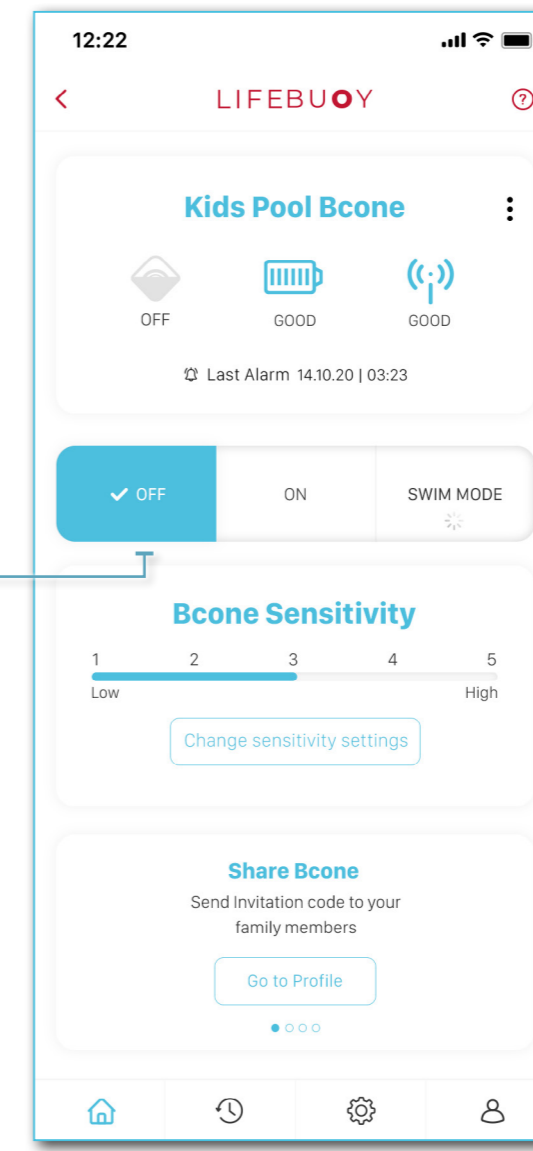



## SWIM MODE

"Swim" mode is used when the pool is in use. When BCone® Solo senses several minutes without activity, it goes back to On mode automatically.

Activate Swim mode using the mobile application as follows:

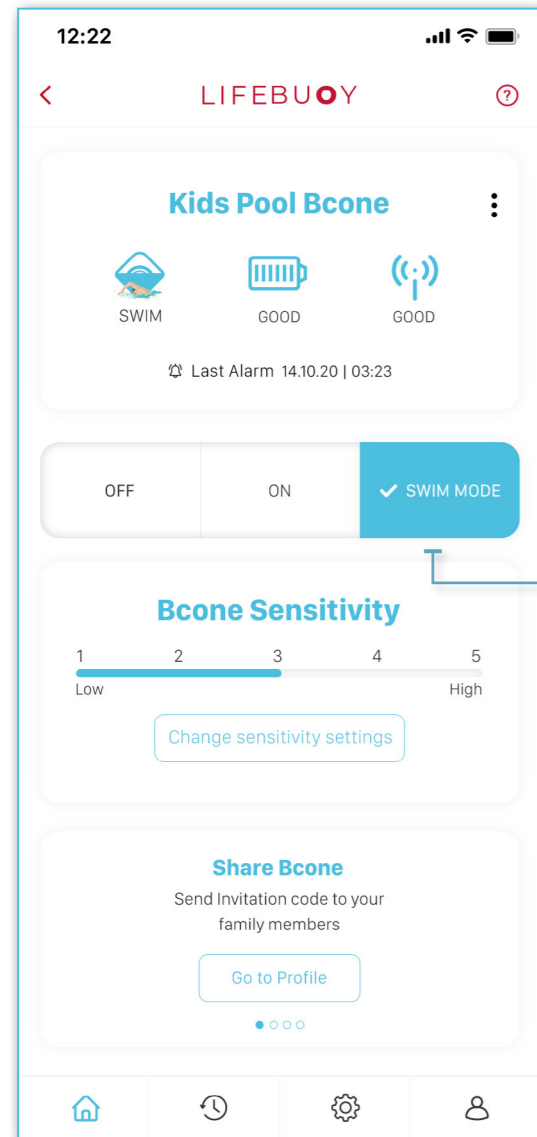

Tap **Swim Mode** to switch to Swim mode.



**TIP:** Switching to Swim mode is also possible by taking the Pool Unit out of the water and holding it vertically for a few seconds. The Pool Unit beeps twice to indicate it is in Swim mode.



**NOTE:** While In Swim mode, the Pool Unit does not sound an alarm.

## ADJUSTING SENSITIVITY

BCone® Solo sensitivity levels determine the reaction of the Pool Unit to water movement. Perform the following steps to set the sensitivity level:

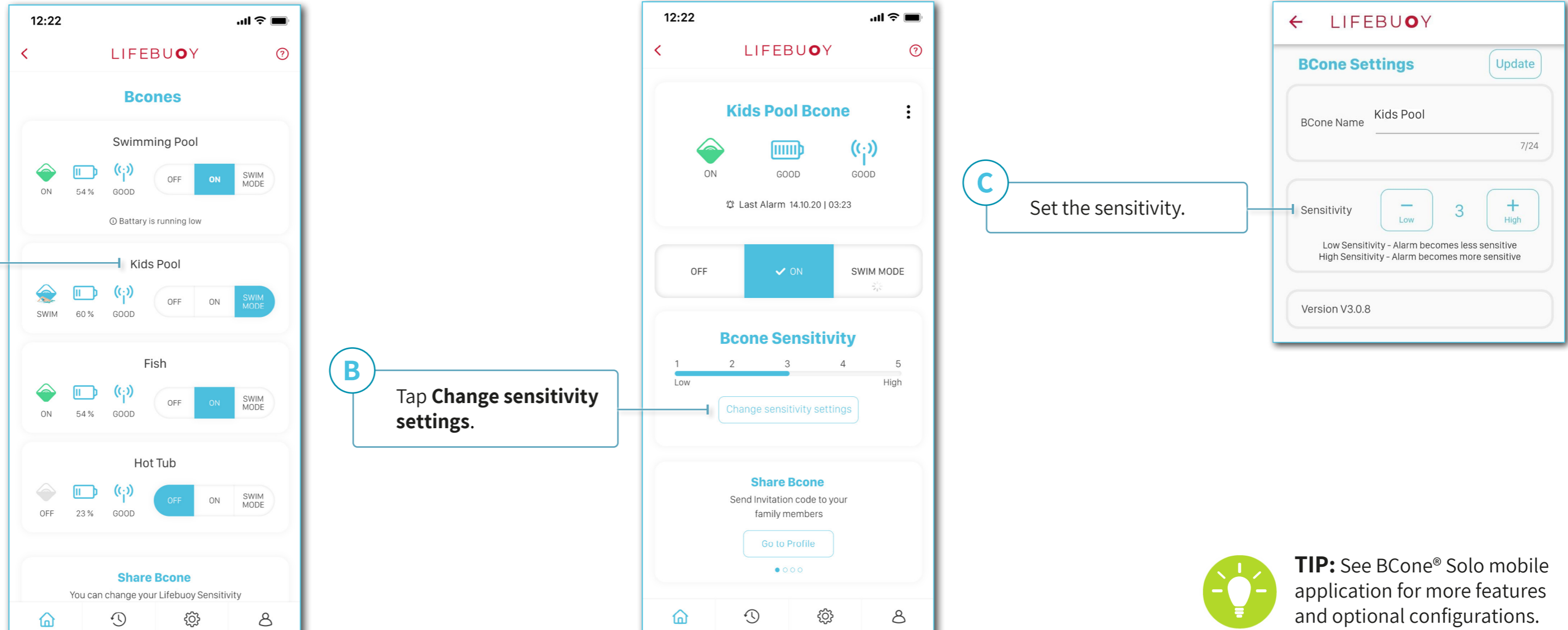

**A** Select the relevant BCones® Solo.

**B** Tap **Change sensitivity settings**.

**C** Set the sensitivity.

**NOTE:**

- The lowest sensitivity level means the Pool Unit sensor is triggered only by sizable waves.
- The highest sensitivity level means the Pool Unit sensor is triggered by smaller ripples or waves.
- The default sensitivity level is 3.

**TIP:** See BCones® Solo mobile application for more features and optional configurations.

## TURNING ALARM OFF

When BCone® Solo is triggered, the following indications occur:

The Pool Unit sounds an alarm, and the **mobile application** displays a notification.



**NOTE:** The mobile application displays a notification only when the Pool Unit is within Bluetooth range of the mobile device.

The Pool Unit LEDs blink red.

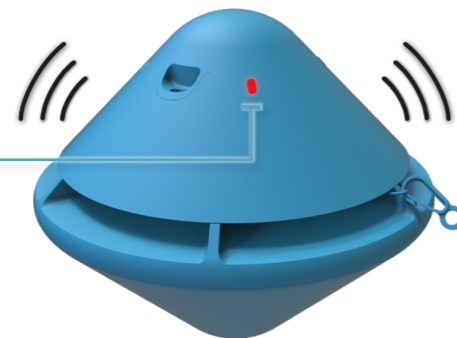

**After checking the pool and verifying that no one is in danger of drowning,** perform one of the following options to silence the alarm:

Swipe the screen on the **mobile application**.

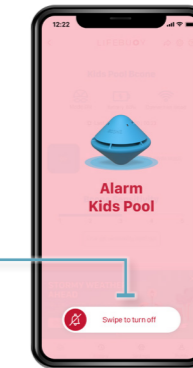

Take the Pool Unit out of the water and hold it vertically for a few seconds. The Pool Unit will beep twice to indicate it is in Swim mode.

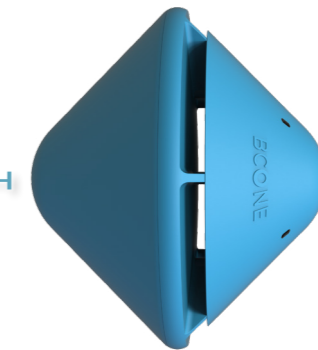

**NOTE:** Once the alarm is silenced, BCone® Solo switches to **Swim Mode** and automatically turns back on once the pool is calm for several minutes.

## SERVICE

This chapter reviews the BCone® Solo service and includes:

- [Troubleshooting](#)
- [Replacing Pool Unit Batteries](#)
- [Shut Down and Storage](#)
- [Technical Specifications](#)



**NOTE:** Should any issues arise with the Pool Unit, contact technical support:

**Website** – [www.lifebuoyalarm.com](http://www.lifebuoyalarm.com)

**Email** – [support@lifebuoyalarm.com](mailto:support@lifebuoyalarm.com)

**Phone** – 1-800-720-7160 (toll free in US & Canada only)



**CAUTION:** Opening the Pool Unit for service or maintenance must be done by qualified service personnel only, with the exception of opening the Pool Unit battery compartment to replace the batteries (see [Replacing Pool Unit Batteries](#)).

## TROUBLESHOOTING

To reduce/avoid false alarms, perform one or more of the following actions:

Shorten the string to less than 5" (12.5 cm) to reduce Pool Unit movement.

Place Pool Unit far from the pump outlets and pool skimmers.

Attach the Pool Unit to the side of the pool using the provided attachment kit (see [Setting Up the Pool Unit](#)).

Remove toys and other floating objects from the pool.

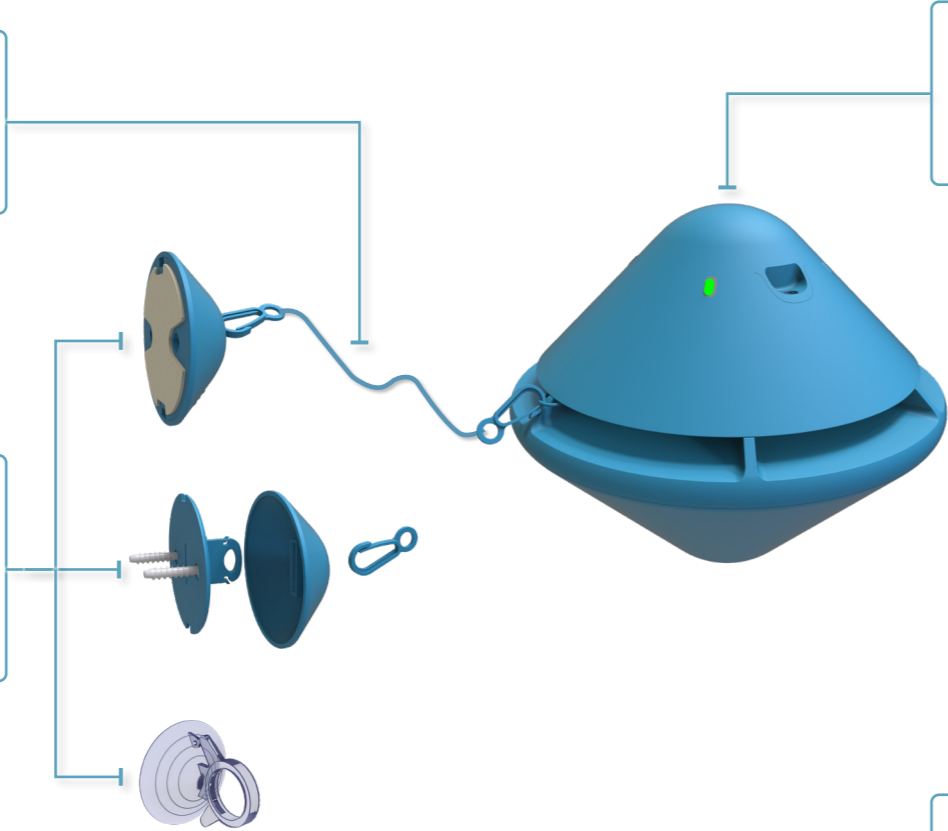

Reduce Pool Unit sensitivity.

- Lower sensitivity – alarm becomes less sensitive.
- Higher sensitivity – alarm becomes more sensitive.

See [Adjusting Sensitivity](#).

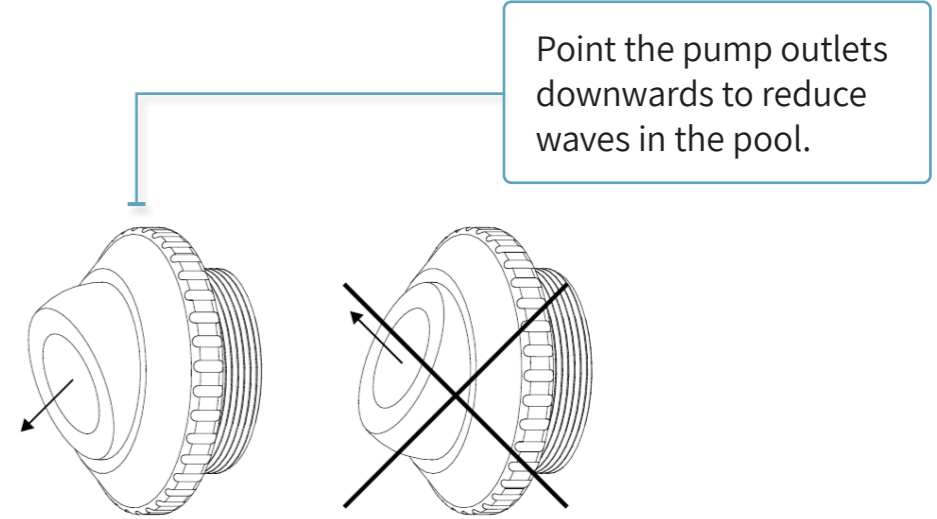
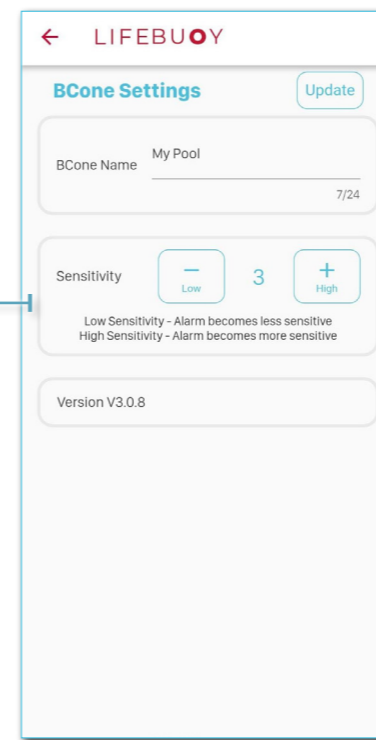

Set Do not Disturb mode to turn on during the night.

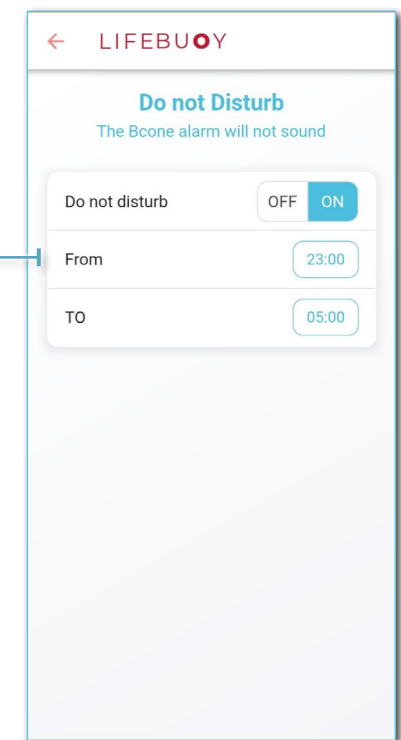

## REPLACING POOL UNIT BATTERIES

The Pool Unit is delivered with two Alkaline batteries already installed. Perform the following steps to change the Pool Unit batteries:

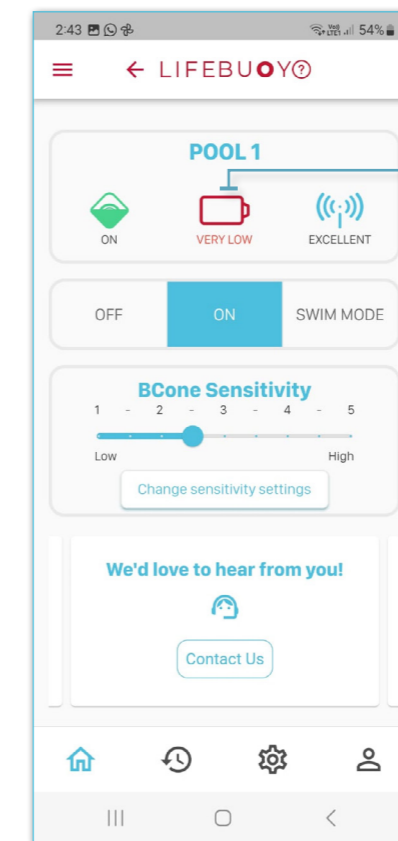
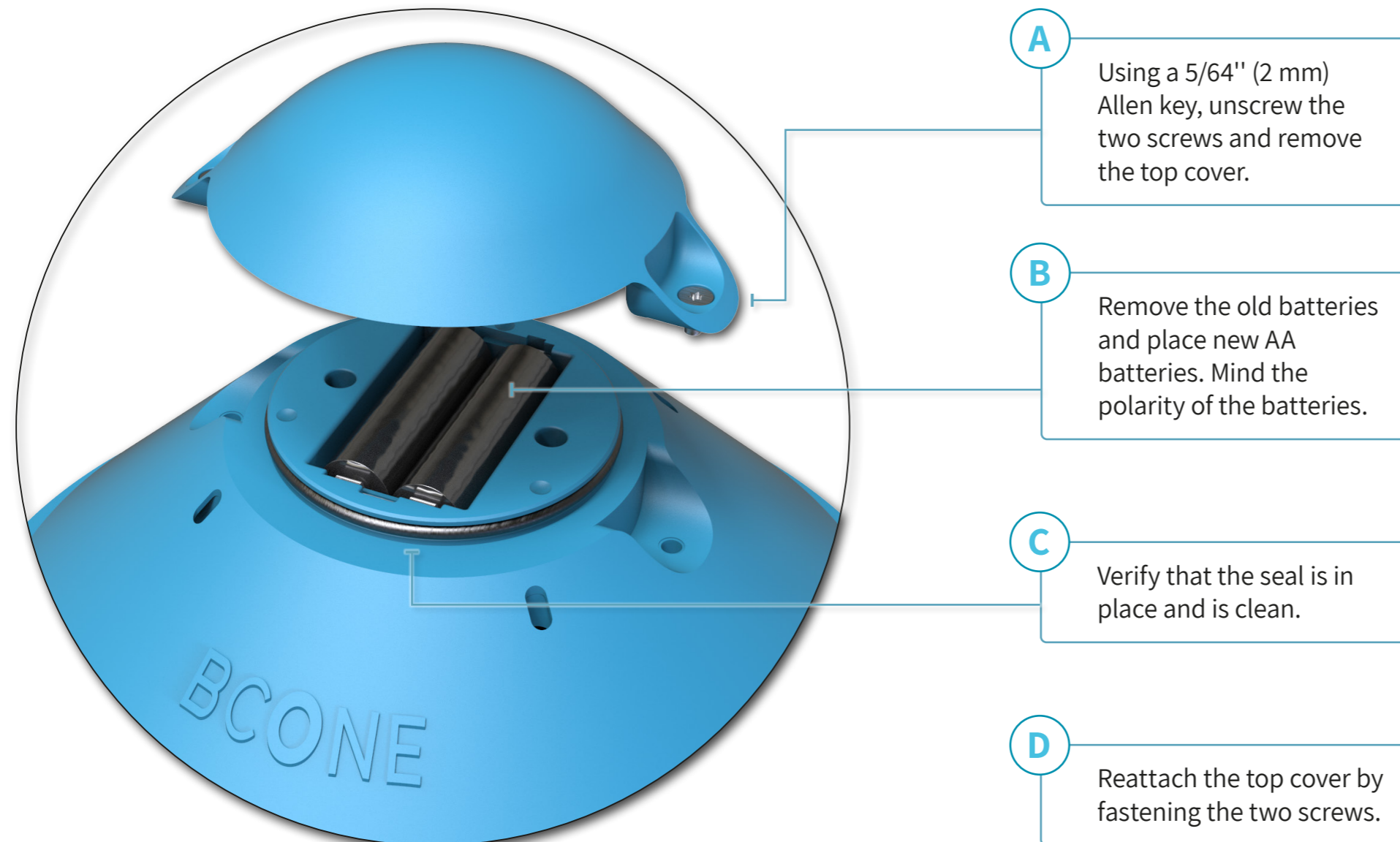

**NOTE:** When the application indicates low battery, it is advisable to change the batteries as soon as possible.

**TIP:** For best performance use the Alkaline batteries provided by Lifebuoy®, available on the company website.

## SHUT DOWN AND STORAGE

During the off season, perform the following steps to shut down and store BCone® Solo:

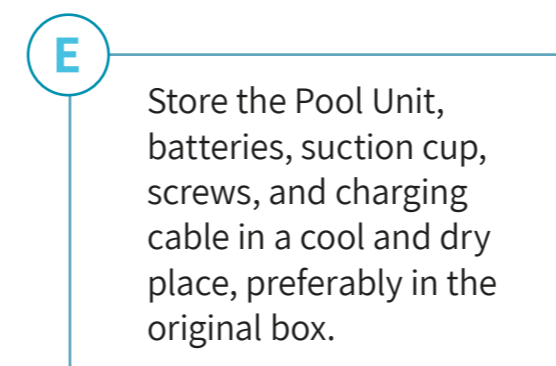
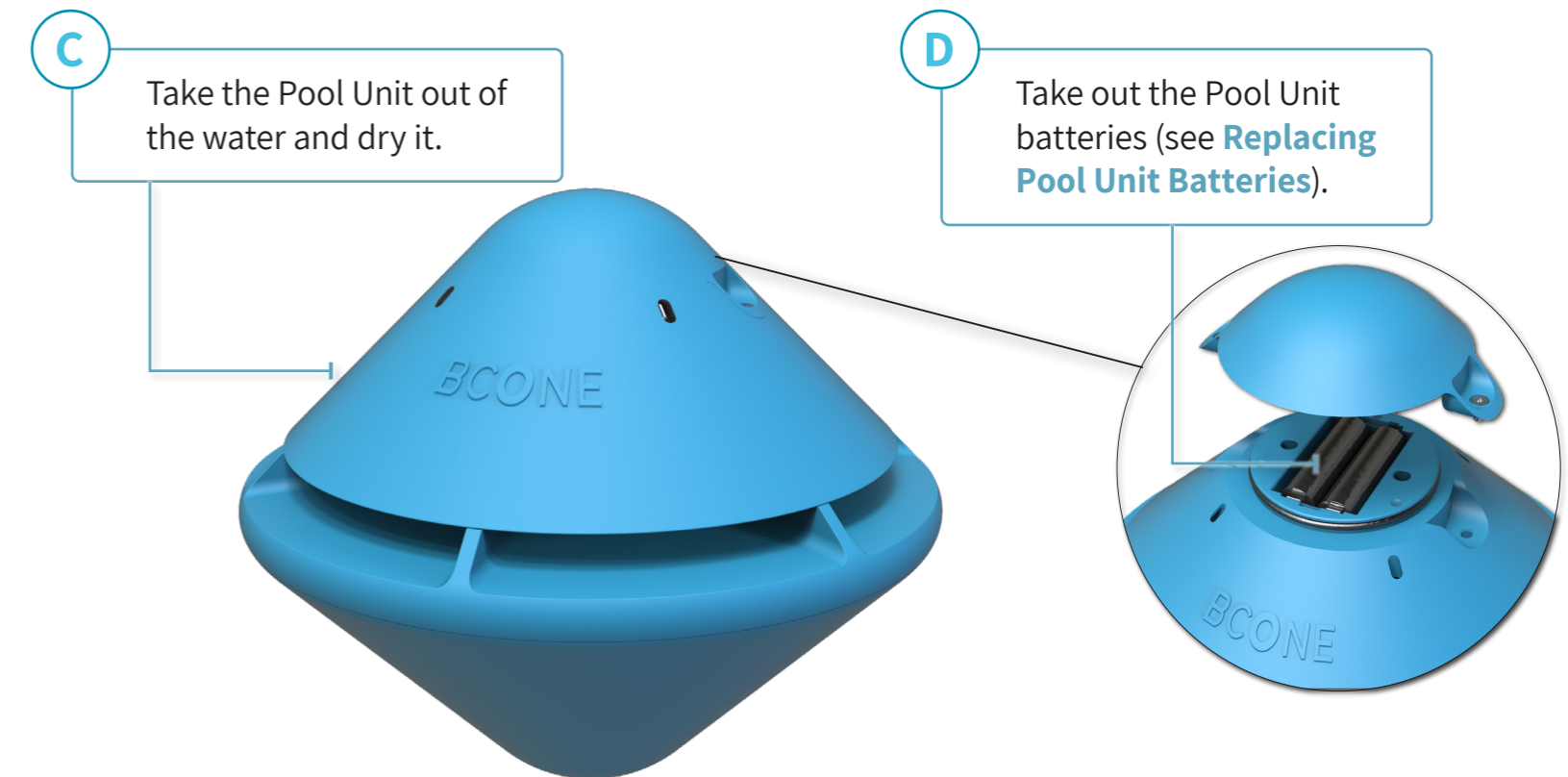
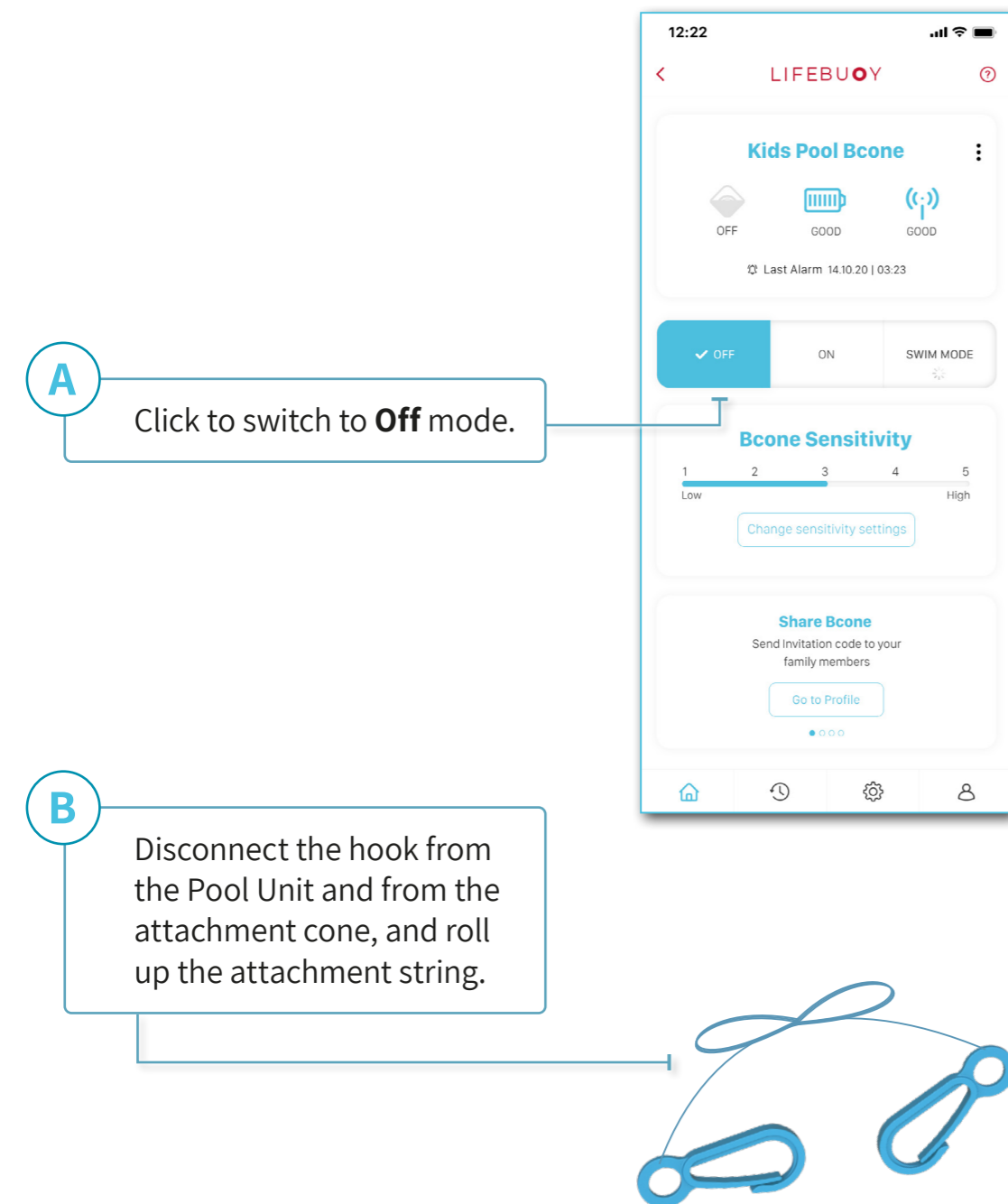

**NOTE:** Do not remove the attachment cone if it is attached using double sided tape or if it is anchored using screws.

## TECHNICAL SPECIFICATIONS

BCone® Solo includes the following specifications:

- **BCone® Solo Pool Unit model** – LBPABCPU01
- **Alarm level of Pool Unit** – 85 dB at 10 feet
- **Ambient temperature range** – 32°F - 113°F (0°C - 45°C)
- **Pool Unit batteries** – two 1.5 V AA Alkaline batteries



**CAUTION:** AA Alkaline batteries may explode or leak if recharged, inserted improperly, or disposed of in fire. Do not open the batteries.

## CONTACT INFORMATION

**Manufacturer** – Lifebuoy® Ltd.

**Website** – [www.lifebuoyalarm.com](http://www.lifebuoyalarm.com)

**Email** – [support@lifebuoyalarm.com](mailto:support@lifebuoyalarm.com)

**Phone** – 1-800-720-7160 (toll free in US & Canada only)

**QR Code for downloading mobile application:**



**DESIGNED BY LIFEBOUY® IN ISRAEL  
ASSEMBLED IN ISRAEL AND PRC**



**THANK YOU!**



Yuvalim Business Campus  
Ness Ziona, ISRAEL



[info@lifebuoyalarm.com](mailto:info@lifebuoyalarm.com)

Copyright © 2023 Lifebuooy®, all rights reserved. No part of this publication may be reproduced, transmitted, transcribed, stored in a retrieval system, or translated into any language or computer language, in any form or by any means, electronic, mechanical or otherwise without prior written permission of Lifebuooy®.

Rev A | Doc P/N: BS-00-70-002