

GENERAL SAFETY INSTRUCTIONS

- Read the entire **BCone Installation and Operation Guide** prior to use (found at www.lifebuoyalarm.com or in the app).
- BCone is exclusively a safety device, not a lifesaving product.



Scan the QR code to open BCon support webpage, which includes the operation guide, video tutorials, and FAQ.



Thank you for purchasing an additional BCone pool unit!

The unit can be quickly integrated into your existing BCone system by performing the following simple steps:

PAIRING



1 Hold the home unit as close as possible to the pool unit.

2 Press and hold the SELECT DEVICE button for 5 seconds. The pairing icon lights up.

3 LEDs blink on both units and five short beeps are heard, indicating successful pairing.

OPERATING

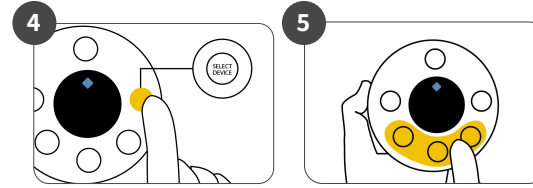

4 Press the SELECT DEVICE button to light the LED of the relevant pool unit.

5 Press one of the operation mode buttons to turn on the desired mode.



NOTE: Install two pool units according to the drawing on the right. For instructions on installing a unit, refer to the BCone Installation and Operation Guide.

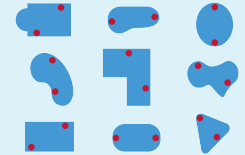

WE'D LOVE TO HEAR FROM YOU!

www.lifebuoyalarm.com | support@lifebuoyalarm.com

1-800-720-7106 (toll-free call in US & Canada only)